

Slimline Propeller Pump Series

Flygt PL-7000



Flygt Slimline Propeller Pumps



Flygt Propeller Pump Family



Flygt Propeller Pump Family



Slimline Pump Series

Typical Applications

- Storm water & Flood protection
- Open channel irrigation
- Treatment plant
 - RAS, WAS and Sludge pumping
- Effluent pumping
- Water ride applications
- Drainage & Dewatering
- Sea water & Raw water intakes
- Screened wastewater
- Aquaculture



Slimline Propeller Pump Models

PL-7020, PL-7030, PL-7035, PL-7040



- (4) new, modern industry leading features:
 - Industry leading hydraulic efficiencies
 - Leading motor efficiencies
 - Self-cleaning N-hydraulics
 - Reduced discharge column size
- Result: Smaller pump station footprint
- Replaces (5) existing pump models:
 - PL-7045 / PL-7050 / PL-7055
 - LL-3201 / LL-3300



Slimline Propeller Pumps



Power and a more compact pump station

Model	Power 60Hz	Pump Column Dia.
PL-7020	27-hp to 40-hp (4-p, 6-p)	16-inch
PL-7030	38-hp to 68-hp (6-p)	20-inch
PL-7035	90-hp to 165-hp (4-p)	22-inch
PL-7040	80-hp to 155-hp (6-p)	24-inch



Slimline Performance Field

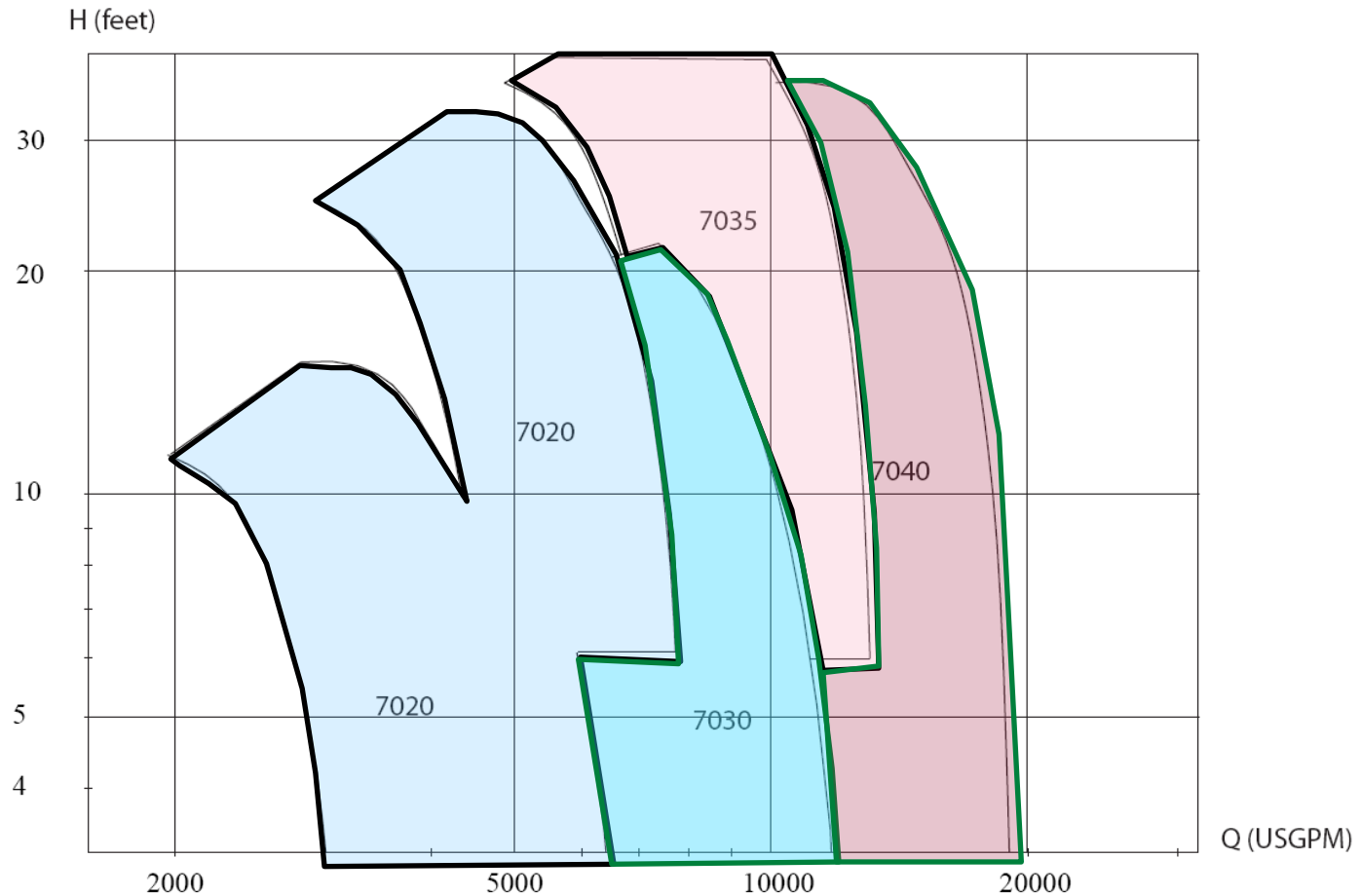

PL-7000 Series Performance Field

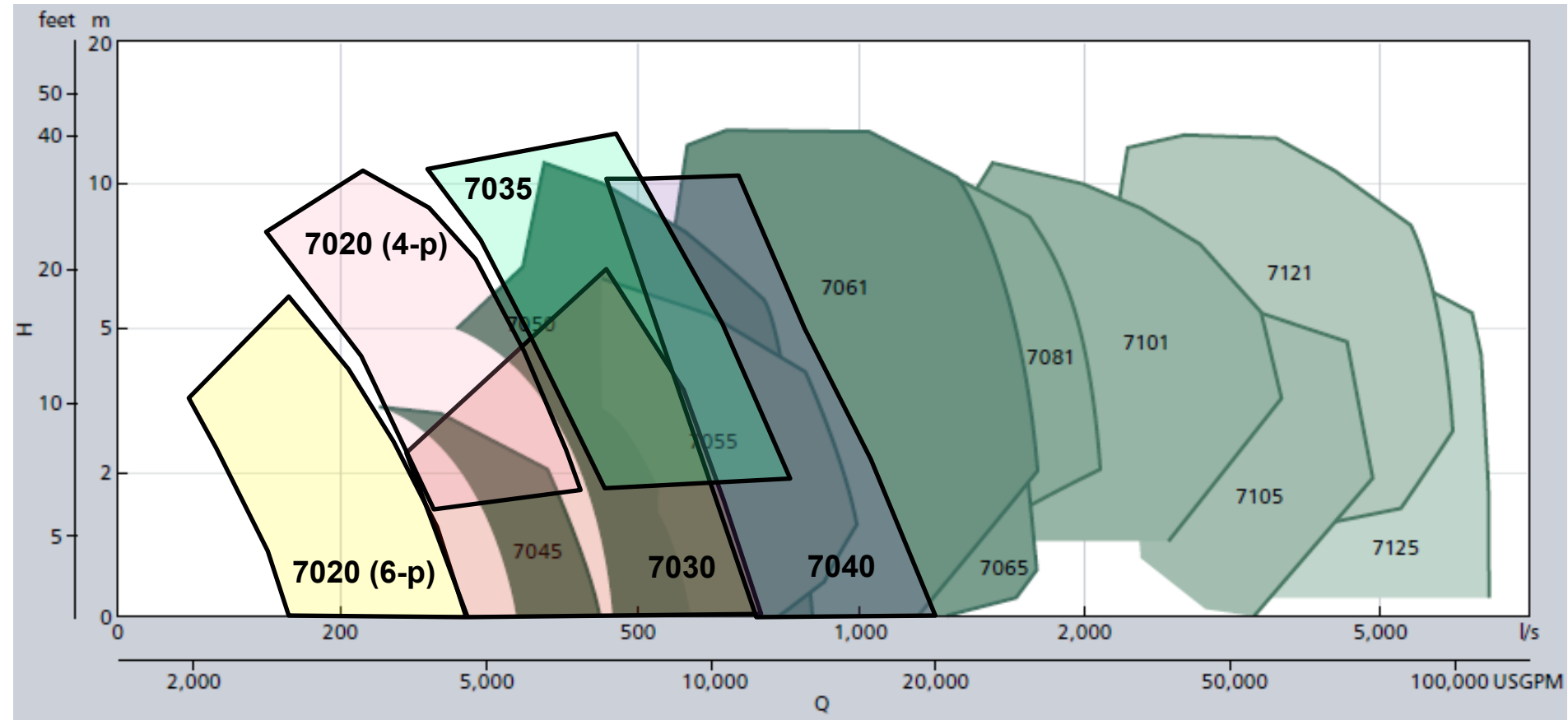

PL-7030-16-deg

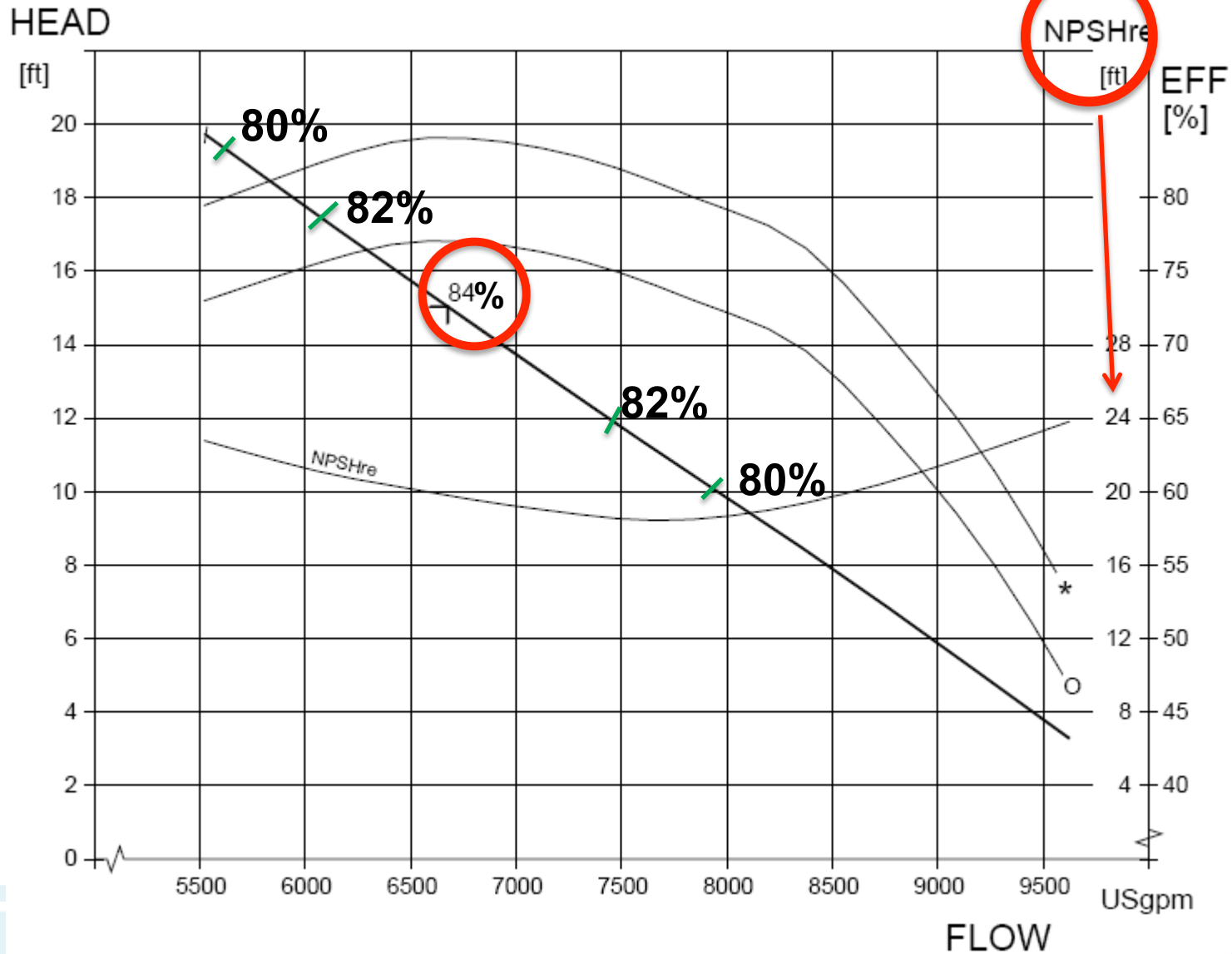

PL-7030 Performance Field

(15 curves from which to choose)

Head (ft.)

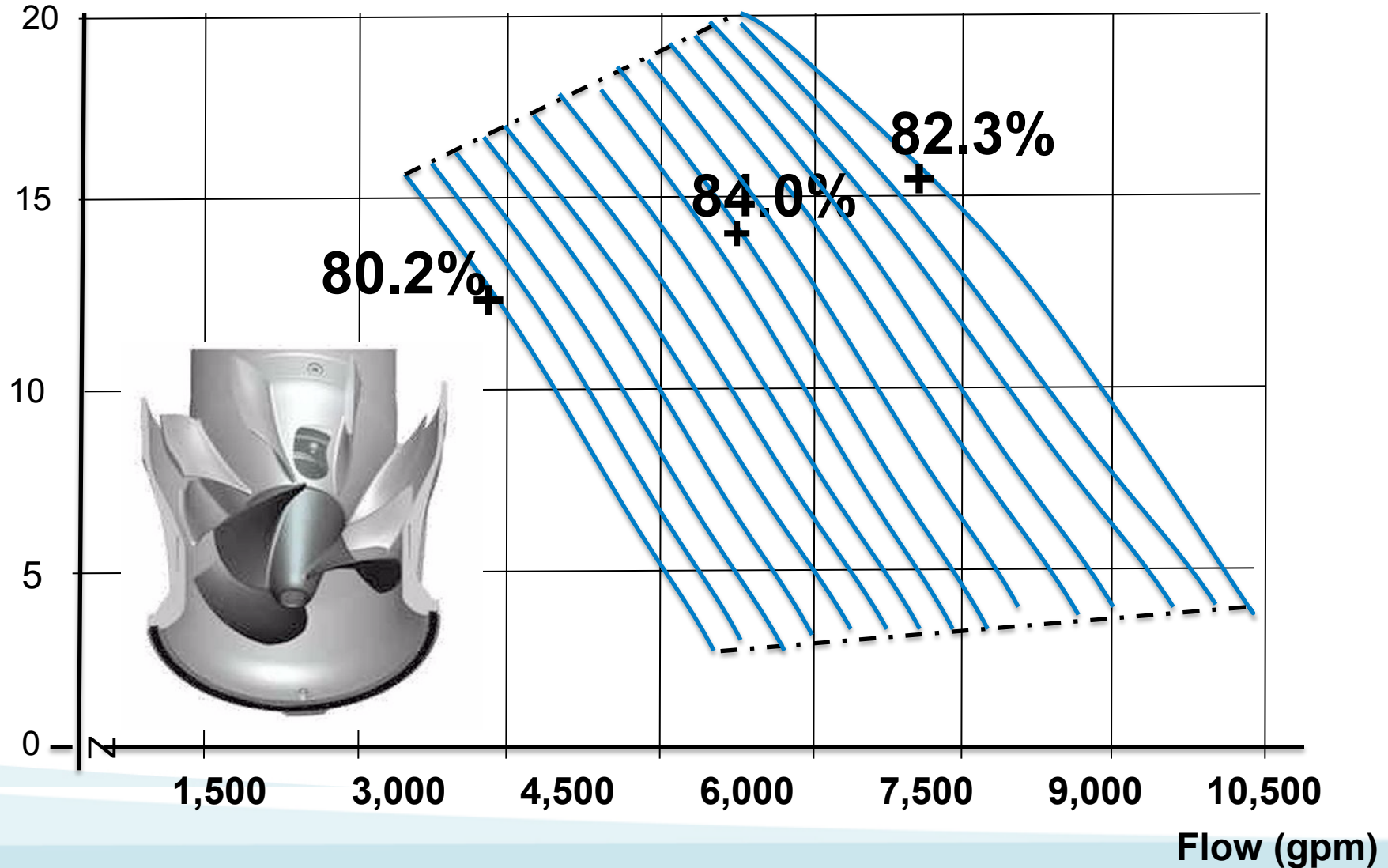

How We Get 15 Pump Curves

3-Throat Diameters

X

5-Blade Angles

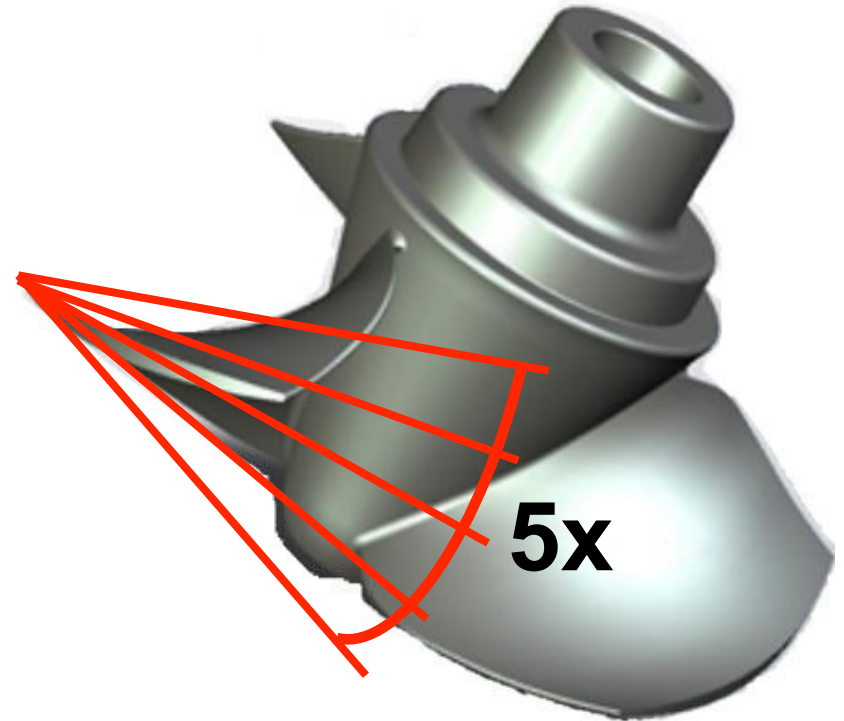

Pump Features



**Class H motor insulation w/
embedded thermal sensors.**

**Guide vanes are self-cleaning
The leading edge sweep
combines with a radius
increase.**

**Optional zinc
anodes**

**N-technology bell mouth
has integrated:**
- Wear ring
- Relief groove

**The pump top gives a
smooth transition at the
outlet of the pump helping
minimize friction losses.**

**Large inspection chamber
with leakage sensor
minimizes bearing and
stator failure.**

**Plug-in™ seal w/ Active
Seal™ system increases
sealing reliability,
reduces risk of bearing
and stator failure.**

**N-technology propeller
is self-cleaning, corrosion
and wear resistance.**

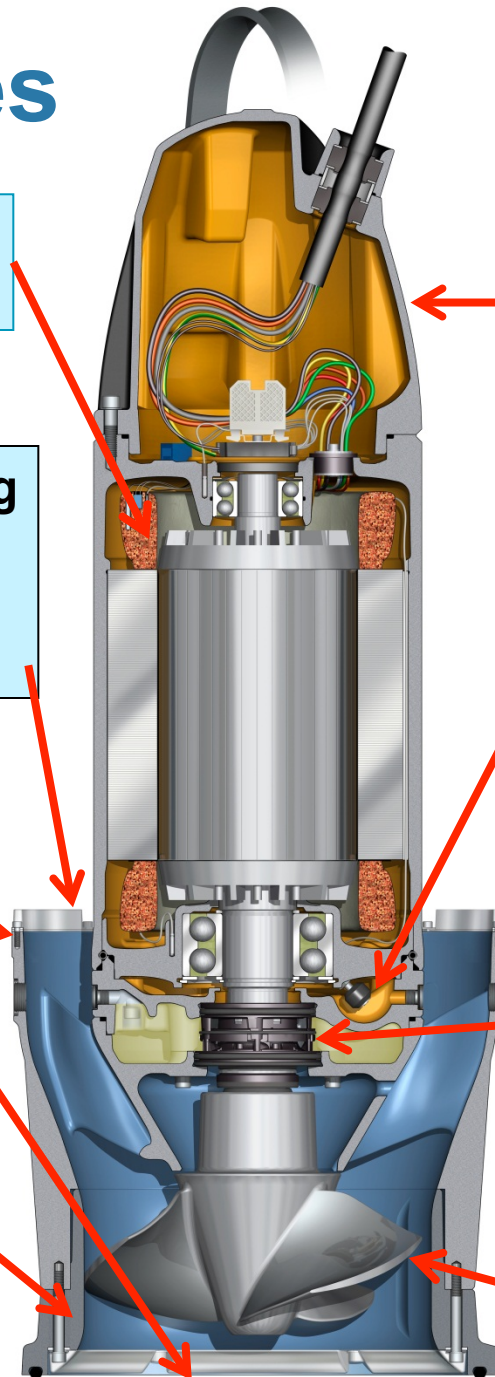

Pump Materials

**All fasteners:
Stainless steel type
ASTM 316**

**Lifting handle:
Stainless steel type
ASTM 316L**

**Major castings:
Cast iron type
ASTM-A 48 – No. 35 B**

**Shaft:
Martensitic stainless steel
Type ASTM 431**

**Insert Ring: Hard Iron™
ASTM A 532 – Alloy III A.**

**Propeller:
Stainless steel Type
ASTM A 743 CF-8M**

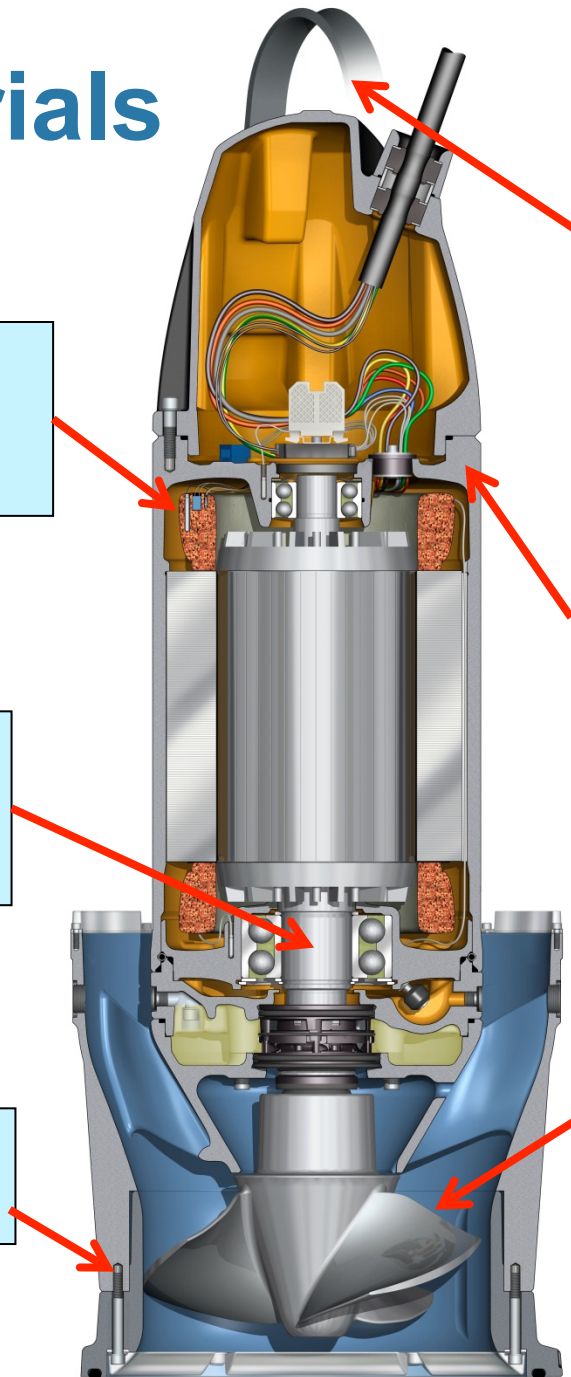

Pump Sensors

VIB-10 Vibration Sensor

Pump Memory

(3) Stator Thermal Switches

PT-100 Lower Bearing Temperature Sensor

FLS in Stator Housing

PT-100 Temperature Sensor

FLS in Leakage Chamber

 **Standard**
 **Optional**

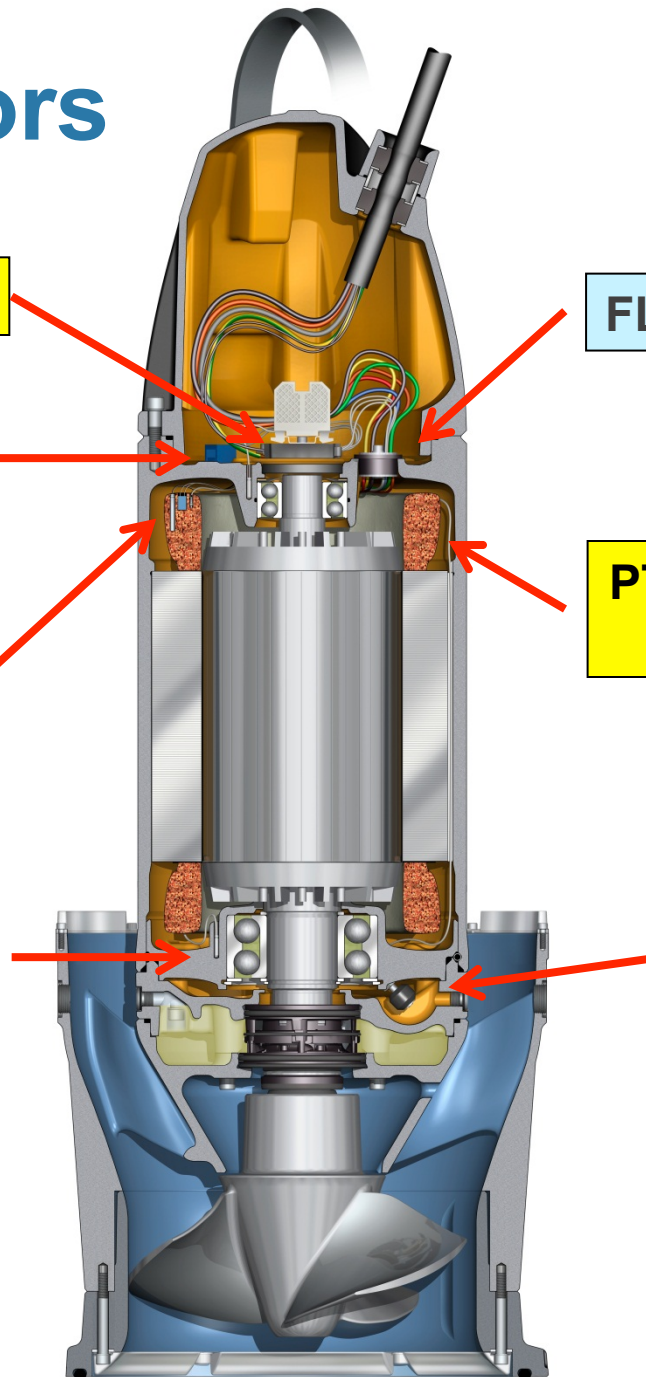

Slimline Pump Monitoring

Existing Monitoring

Terminal
block

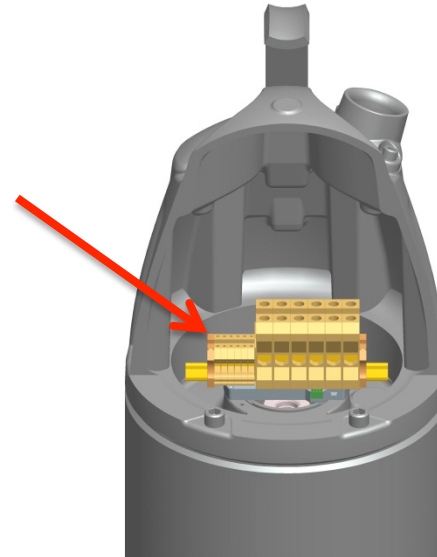

Mini-CAS / MAS-711

- FLS Connection chamber
- (3) Thermal switches
- FLS Stator housing
- FLS Junction chamber
- + Optional sensors

Slimline Pump Monitoring

Basic - Mini-CAS



Optional – MAS-711

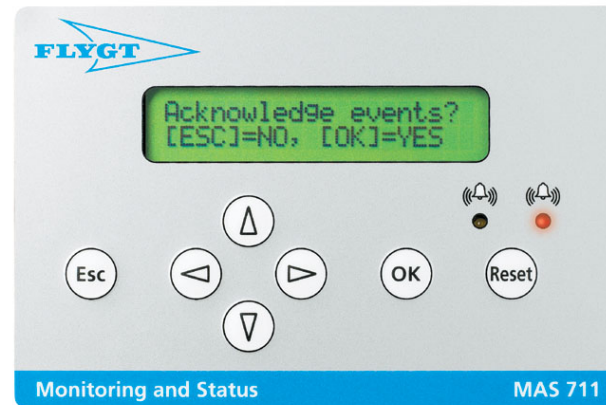

Our Advantages



Specifiable Standard Features

- High hydraulic efficiency
- High overall efficiency
- NRTL (CSA_{US}) general purpose approval
- Smaller discharge tube size
- Single piece cast propeller
- Type 316 SS propeller
- Hard-Iron™ wear ring
- WCCr tungsten-carbide seals (Upper and lower)
- Active™ seal technology
- N-technology, self-cleaning propeller design
- Pump & motor by same manufacturer

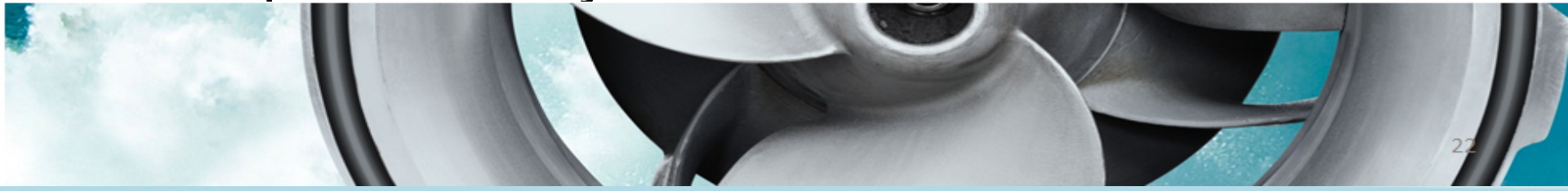

Specifiable Optional Features

- Factory Mutual Approval (Hazardous Location)
- Adapters for retrofit market
- Lifting & cable handling system
- Zinc anodes
- Silicon-Carbide mechanical seal (outer)
- Epoxy coating
- Stainless steel hose cable protection
- Viton O-rings
- Premium efficiency motors, IE3 / NEMA



Higher Efficiency



Higher Efficiency

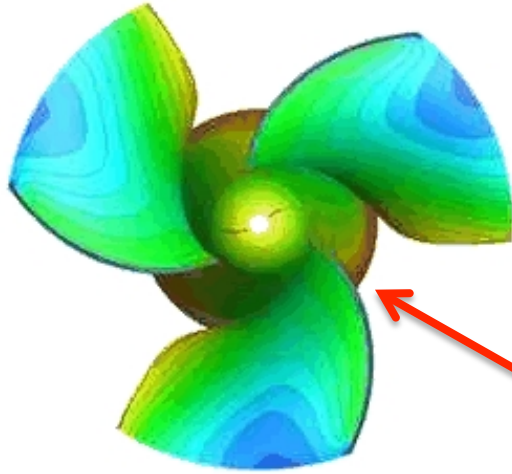

- **Optimized propeller loading**
- **Optimized flow dynamics**
- **Single piece casting in Type 316 SS**
 - Excellent corrosion and wear properties
- ***RepliCast* casting method results in:**
 - Consistently held tight tolerances
 - Highest quality finished casting
 - Superior casting strength

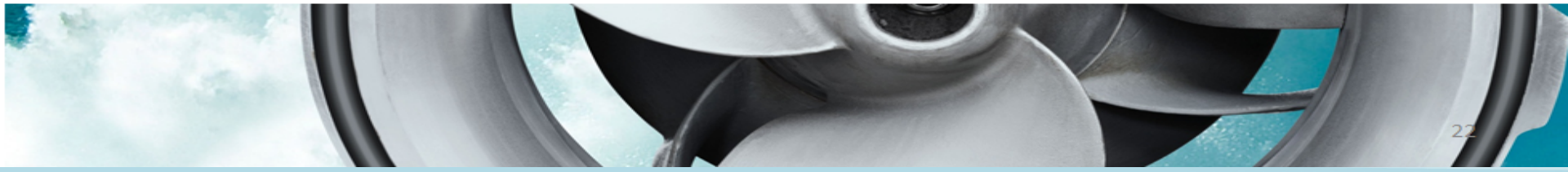
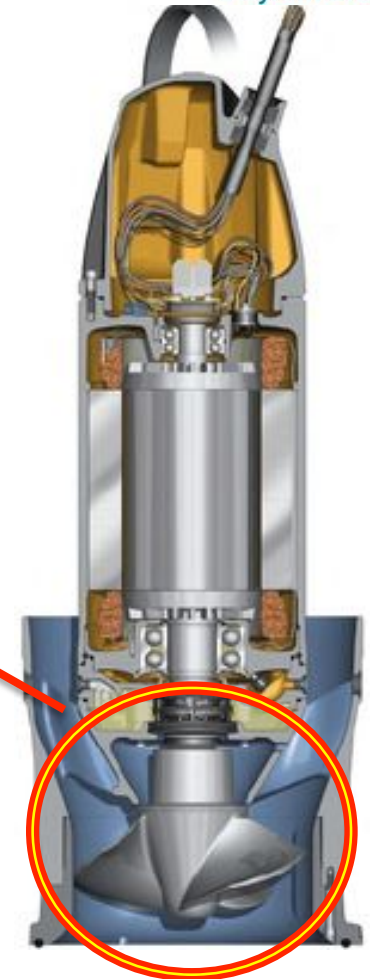

Higher Efficiency

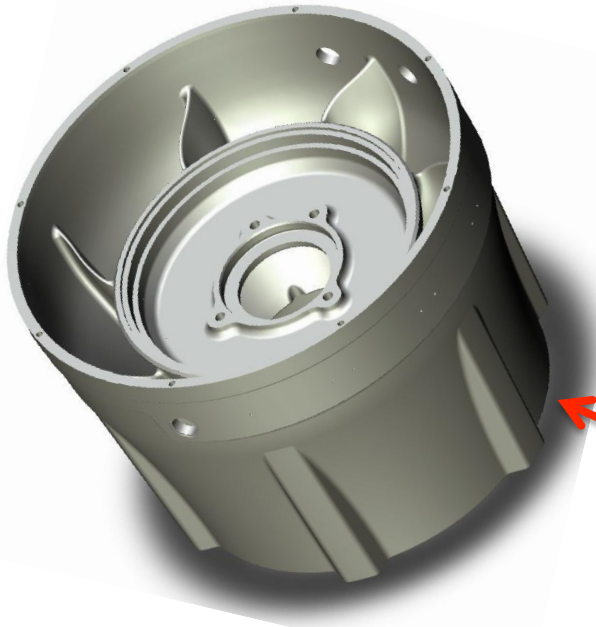

- The diffuser recovers dynamic energy to maximize pump efficiency
- Decreases velocity / Guides the flow
- Self-cleaning guide vane design

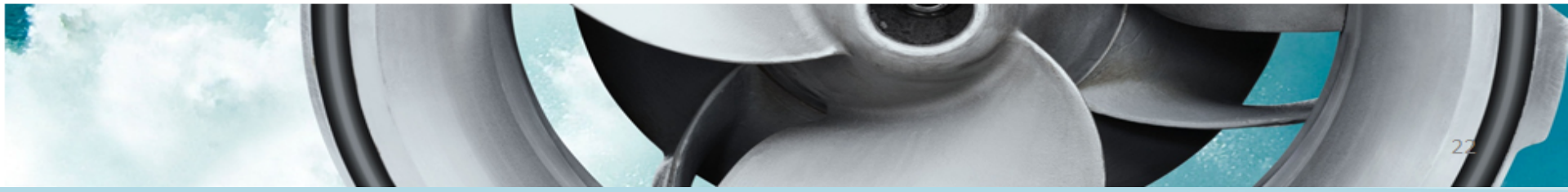
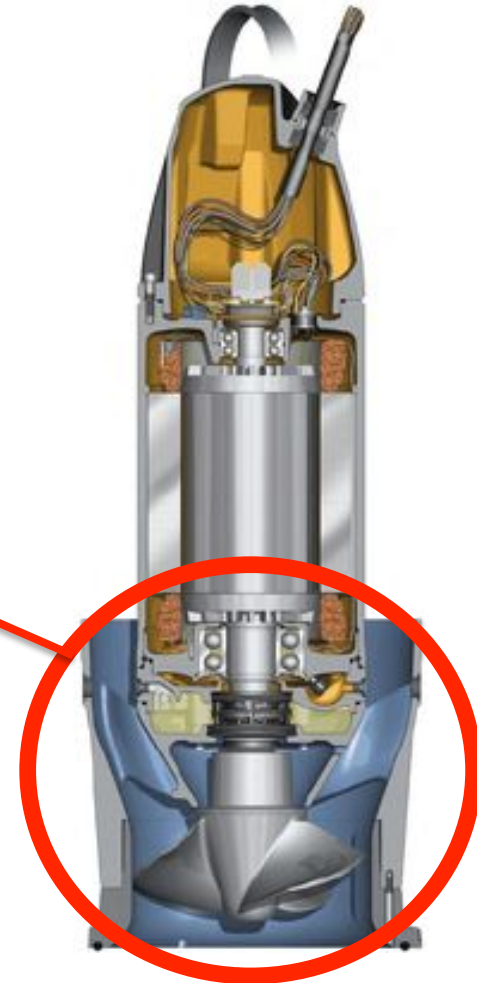

Higher Efficiency

- **Stream-lined pump top**
 - Reduces losses
 - Benefits at pump top
 - Benefits downstream

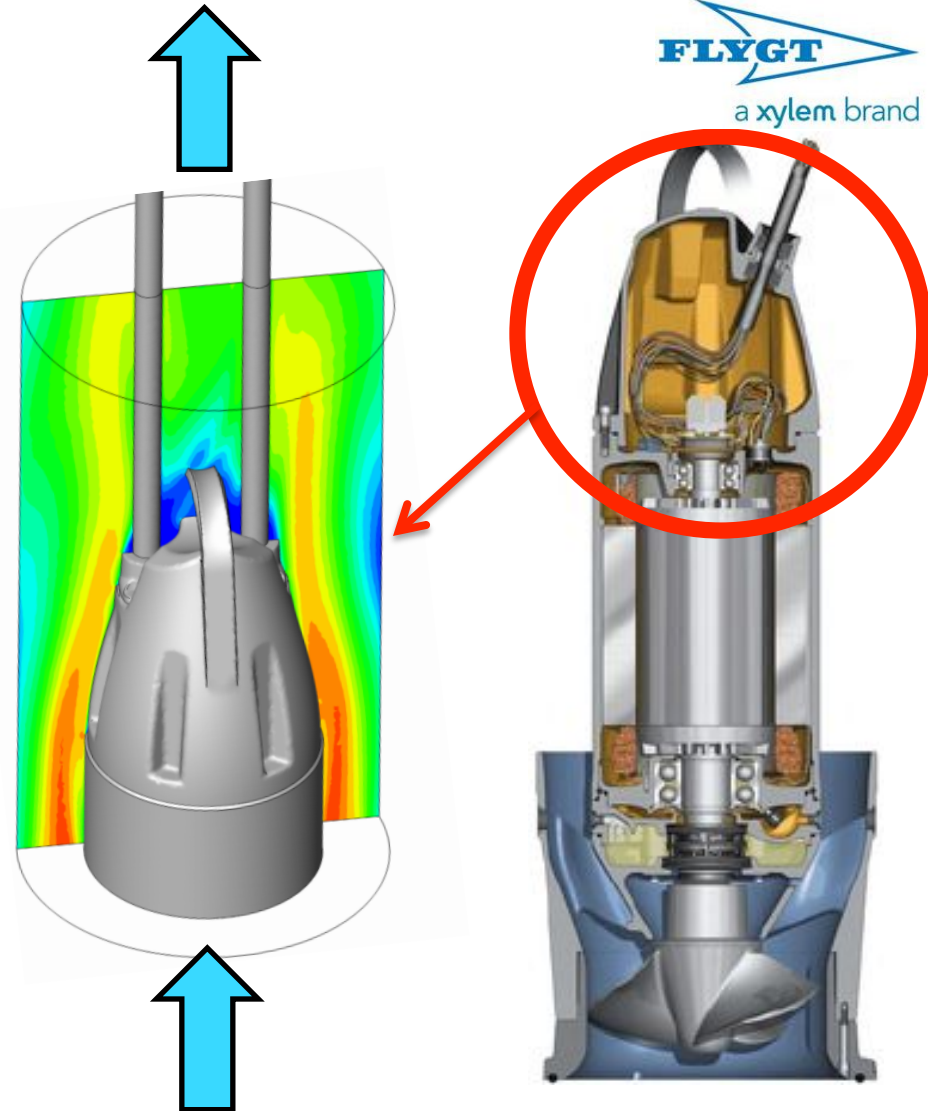

Higher Motor Efficiency

Premium Efficiency Motors

- Available as an option:
 - 4-P and 6-P motors
 - IE-3 / NEMA compliant

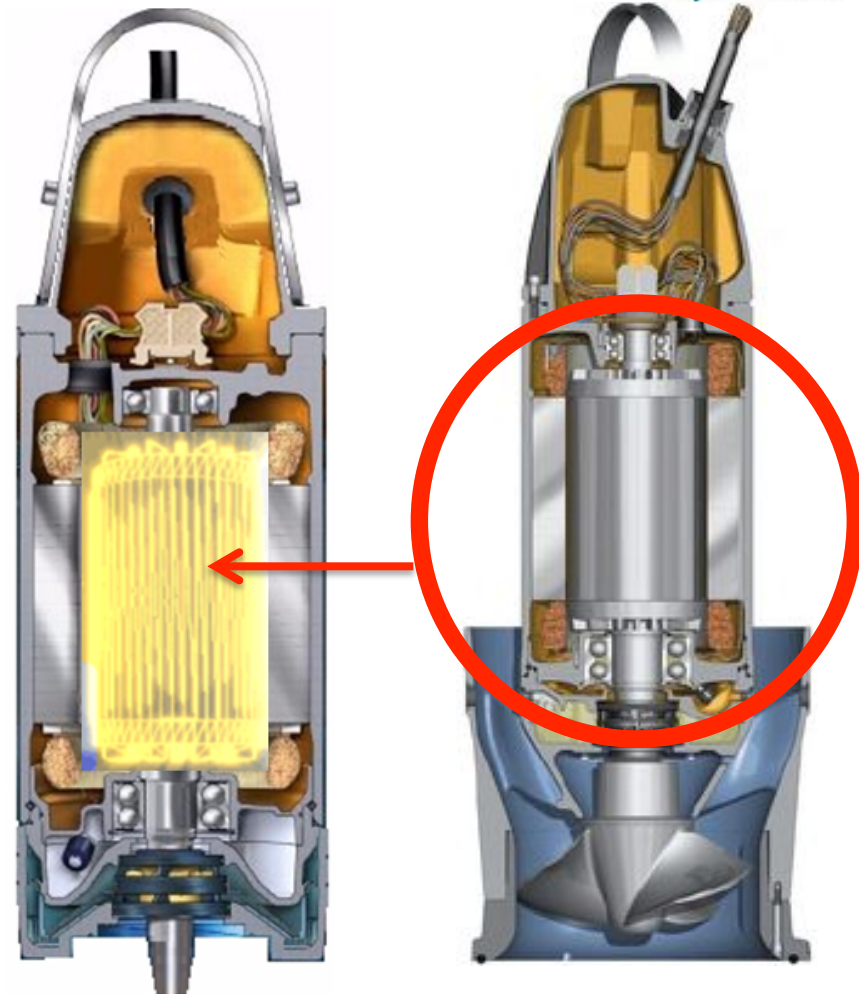

Higher Operational Reliability



High Operational Reliability



Propeller Pump N-Technology:
Self-cleaning propeller blades
with housing relief groove

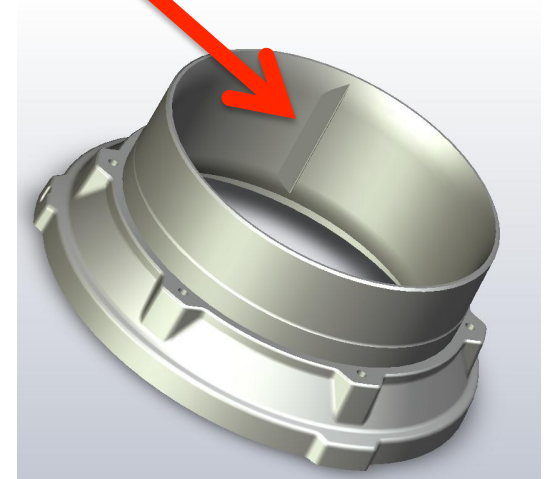

Bell Mouth / Wear Ring

- Increases the liquid velocity with minimum losses
- Has a built in wear ring function with an integrated relief groove for clog resistance
- Cast in high chromium iron for good corrosion and wear resistance
- Acts as a pump rotation prevention during pump start
- Holds zinc anodes

Material: Hard-Iron™

Relief groove

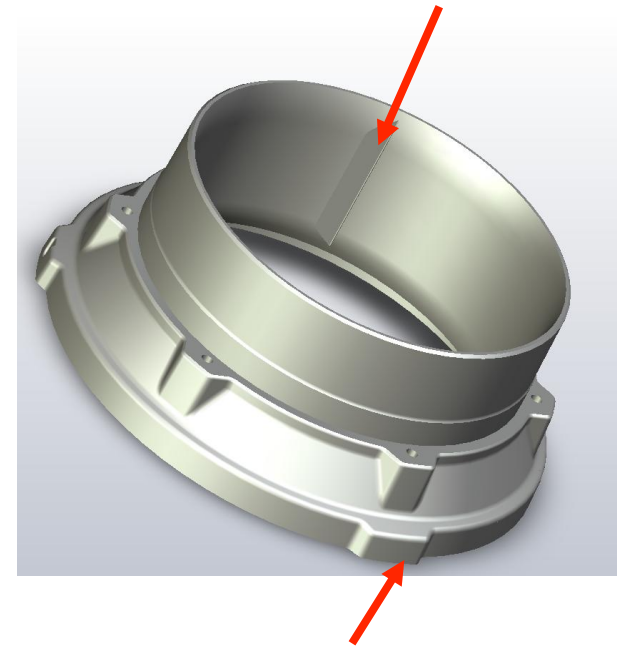

Rotation stop

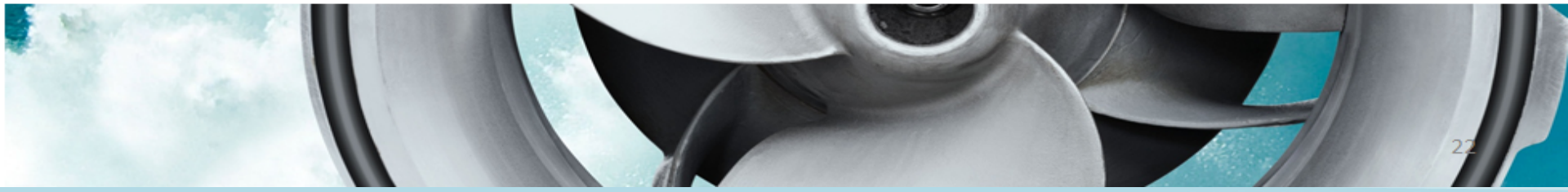

Smaller Pump Station Footprint



Smaller Pump Station Footprint

Station width is based upon tube 'D'

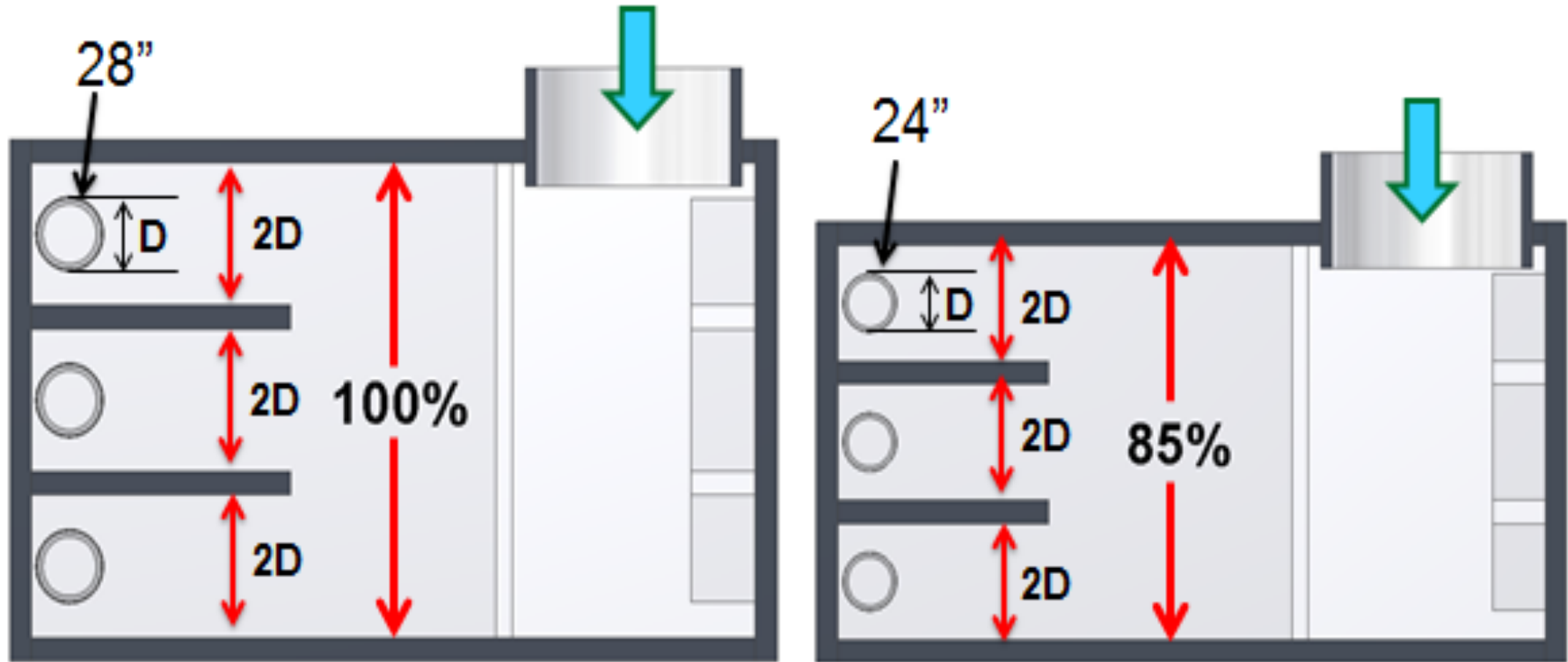

Smaller Pump Station Footprint

- Slimline design yields a smaller pump station

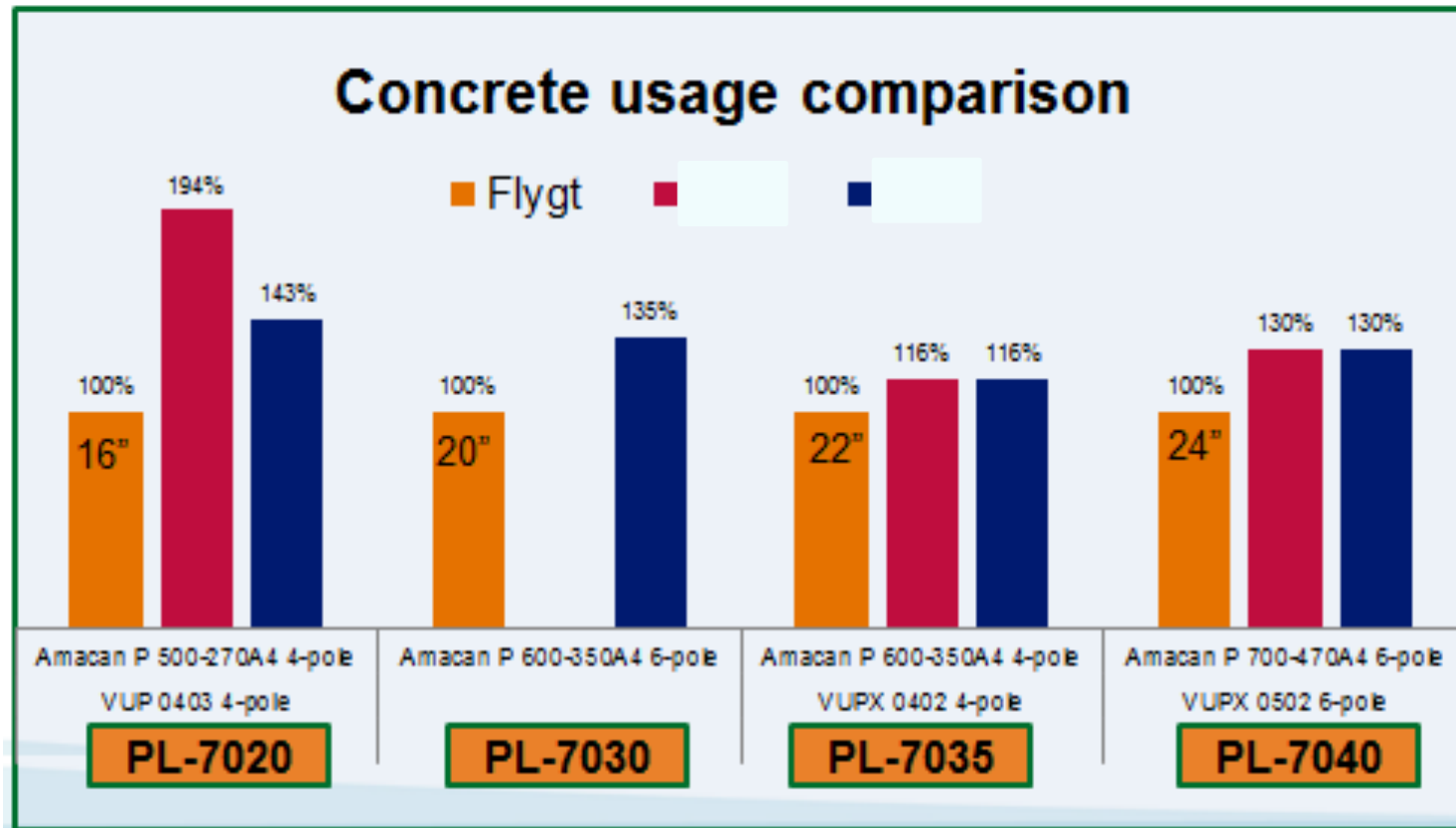

Flygt System Engineering Expertise



Premier System Engineering



Application expertise

Pump selection guidance

Pump station design assistance

Pump retro-fitting support

Reference list holding thousands of installations

Recommendations for a wide range of applications:

- Flood control
- WWTP process
- WWTP effluent
- Dewatering
- Storm water
- WWTP Mid-plant pumping
- Water attractions
- Raw water



Slimline Summary



Primary Features

■ High efficiency

- IE-3 motors
- Premium hydraulics
- N-Technology
- Streamline exteriors

■ Smaller footprint

- Smaller column diameter
- Smaller station footprint
- FSI further reduces footprint

■ Reliability

- Self-cleaning N-Technology
- Cast St. steel propeller
- Active™ seal
- Robust design

■ Installation / Service

- Cable handling system
- Adapters to older Flygt pumps
- Adapters to competitors machines



Retrofit opportunities

- Replace gracefully ageing installed Flygt machines...
- Replace pumps in high duty applications:
- WWTP process (BNR / Recycle / Mid-plant)
- Amusement attractions



Slimline Retrofit Adaptations

Standard Pump Adapter Plates

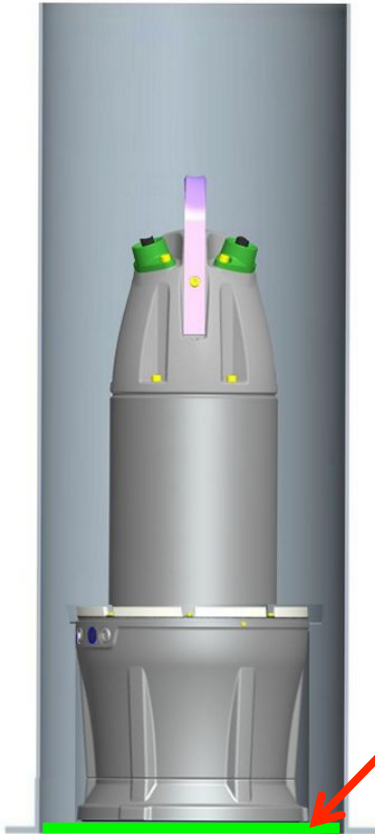

Pump
Adapter
Plates

Custom Pump Mounting Methods



Use of existing
pump column



Inspired by you... Engineered by us.



Slimline Propeller Pump Series

Flygt PL-7000

