



TLC Series

In-line wet rotor circulators for residential systems, fixed speed with manual adjustment.

2

SPECIFICATIONS

Delivery: up to 4 m³/h

Head: up to 7 m

Power supply: single-phase 50 Hz

Power consumption: 27 W to 89 W

Maximum operating pressure:

10 bar

Temperature of pumped liquid:

-10°C to +110°C

Insulation class: H

Protection: IP44

MATERIALS

Pump body: Cast iron cathodically coated

Impeller: Composite material

Shaft: Ceramic

Lower sleeve: Stainless steel

Wear Ring: Ceramic

Bearings: Ceramic

Elastomers: EPDM

APPLICATIONS

- Water circulation in heating and air conditioning systems.
- Pumping of hot/cold, chemically and mechanically non-aggressive liquids.



For a complete list of technical information, consult www.lowara.co.uk

Engineered for life



General Catalogue

2

TLC SERIES – HYDRAULIC PERFORMANCE TABLE

PUMP TYPE	MAXIMUM ABSORBED POWER W	MAXIMUM ABSORBED CURRENT A	CAPACITOR		SPEED	Q = DELIVERY										
			μF	V		l/s	0,2	0,3	0,5	0,6	0,7	0,8	0,9	1,1		
						m ³ /h	0,6	1,2	1,7	2,0	2,4	2,8	3,2	3,9		
H = TOTAL HEAD METRES COLUMN OF WATER																
TLC 15-2.5	27	0,12	1,5	400	1	2,1	2,0	1,5	1,1	0,8						
TLC 25-2.5L	32	0,14			2	2,3	2,1	1,7	1,3	1,1						
TLC 32-2.5L	35	0,15			3	2,5	2,3	1,9	1,5	1,2	0,9					
TLC 15-4	33	0,14	1,5	400	1	3,5	2,7	1,8	1,2	0,8						
TLC 25-4 (L)	39	0,17			2	3,9	3,2	2,4	1,9	1,6	1,1					
TLC 32-4L	44	0,19			3	4,2	3,5	2,8	2,2	1,9	1,5	0,9				
TLC 15-5	43	0,19	2,0	400	1	3,9	2,9	2,0	1,3	0,8						
TLC 25-5 (L)	63	0,28			2	4,8	4,3	3,7	3,0	2,5	1,8	0,9				
TLC 32-5L	77	0,34			3	5,2	4,9	4,4	3,8	3,5	3,0	2,3	1,8			
TLC 15-6	43	0,19	2,0	400	1	3,4	2,3	1,5	0,9							
TLC 25-6 (L)	65	0,28			2	5,2	4,1	3,0	2,1	1,7	1,1					
TLC 32-6L	80	0,34			3	6,2	5,6	4,7	4,0	3,6	3,0	2,4	1,8			
TLC 15-7	54	0,24	2,0	400	1	5,4	3,6	2,5	1,7	1,4	0,9	0,4				
TLC 25-7L	76	0,34			2	6,6	5,5	4,0	2,9	2,3	1,6	1,0	0,4			
TLC 32-7L	89	0,39			3	7,1	6,6	5,9	5,2	4,7	3,9	2,9	2,0	0,4		

Performances according to standards EN 1151-1

tlic-2p50-en_b_th

TLC SERIES – DIMENSIONS AND WEIGHTS

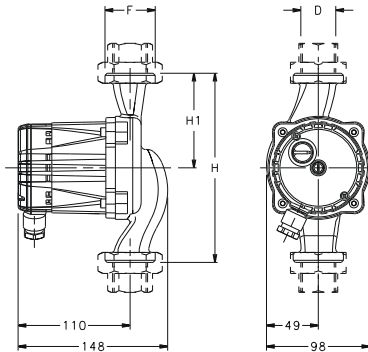

0287L_B_00

Please Note

**TLC 25-5 and TLC 25-6
UK standard versions**

TLC SERIES – DIMENSIONS AND WEIGHTS TABLE

PUMP TYPE	DIMENSIONS (mm)					WEIGHT kg
	H	H1	D	F	DN	
TLC 15-2.5	130	65	1/2"	G 1"	15	2,6
TLC 25-2.5L	180	90	1"	G 1 1/2"	25	2,7
TLC 32-2.5L	180	90	1 1/4"	G 2"	32	2,8
TLC 15-4	130	65	1/2"	G 1"	15	2,6
TLC 25-4	130	65	1"	G 1 1/2"	25	2,7
TLC 25-4L	180	90	1"	G 1 1/2"	25	2,7
TLC 32-4L	180	90	1 1/4"	G 2"	32	2,8
TLC 15-5	130	65	1/2"	G 1"	15	2,6
TLC 25-5	130	65	1"	G 1 1/2"	25	2,7
TLC 25-5L	180	90	1"	G 1 1/2"	25	2,7
TLC 32-5L	180	90	1 1/4"	G 2"	32	2,8
TLC 15-6	130	65	1/2"	G 1"	15	2,6
TLC 25-6	130	65	1"	G 1 1/2"	25	2,7
TLC 25-6L	180	90	1"	G 1 1/2"	25	2,8
TLC 32-6L	180	90	1 1/4"	G 2"	32	2,8
TLC 15-7	130	65	1/2"	G 1"	15	2,6
TLC 25-7L	180	90	1"	G 1 1/2"	25	2,8
TLC 32-7L	180	90	1 1/4"	G 2"	32	2,8

tlic-2p50-en_c_td

Engineered for life



General Catalogue

TLC SERIES SINGLE-PHASE OPERATING CHARACTERISTICS

2

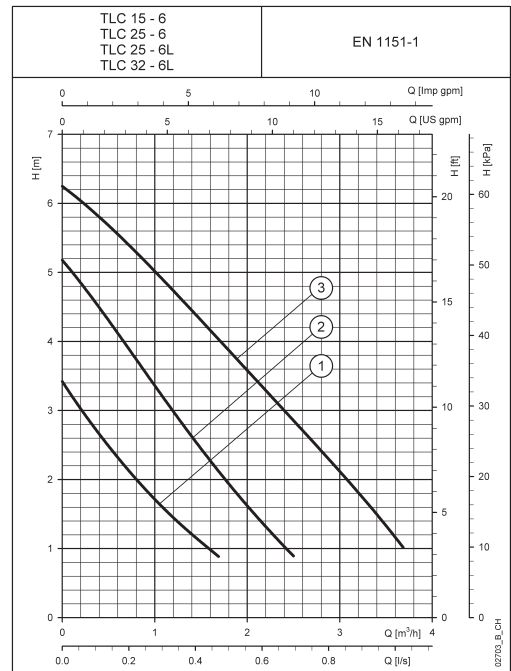
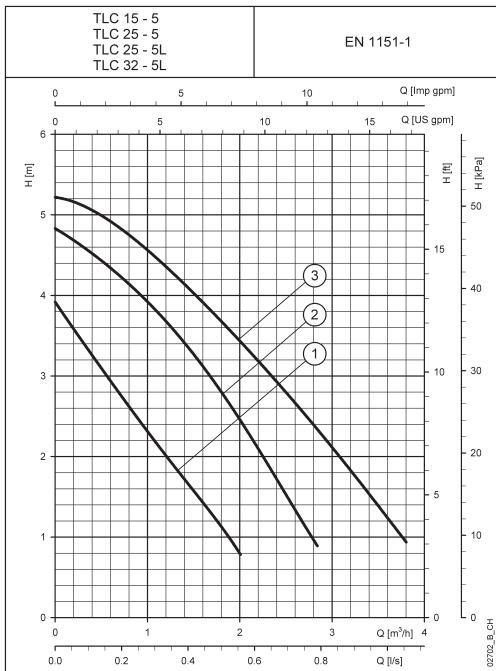
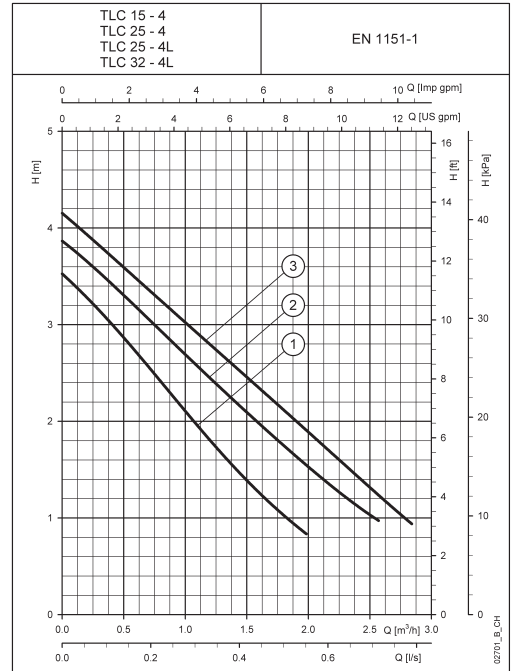
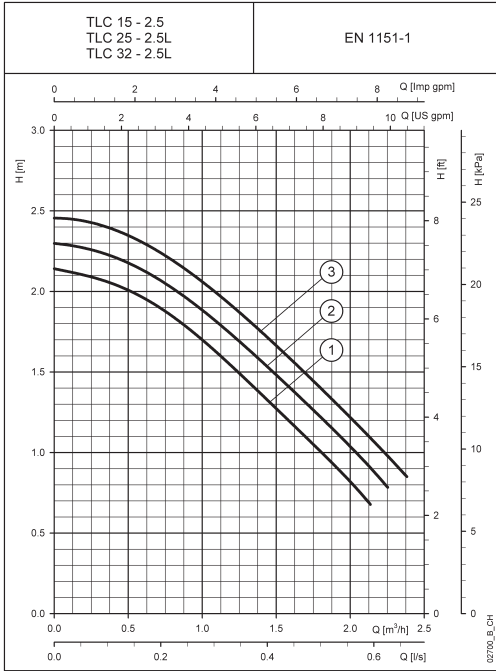

These performances are valid for liquids with density $\rho = 1.0 \text{ kg/dm}^3$ and kinematic viscosity $\nu = 1 \text{ mm}^2/\text{s}$.

Engineered for life



ITT

Lowara

General Catalogue

TLC SERIES SINGLE-PHASE OPERATING CHARACTERISTICS

2

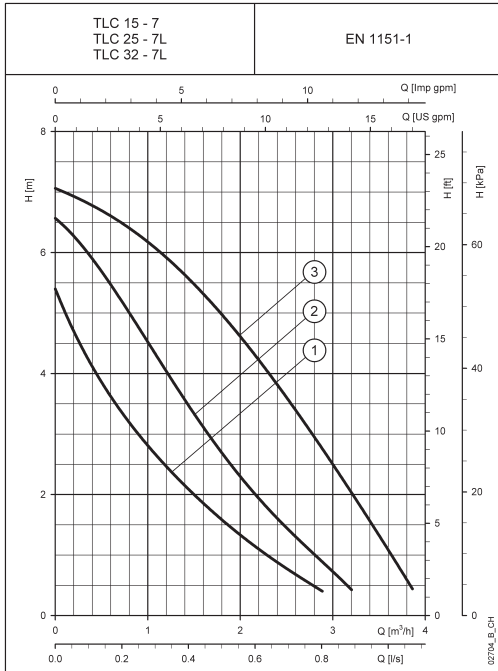

These performances are valid for liquids with density $\rho = 1.0 \text{ kg/dm}^3$ and kinematic viscosity $\nu = 1 \text{ mm}^2/\text{s}$.



Black and white technical books available see www.lowara.co.uk



Engineered for life